



SPA ELECTRICS

Ph: +61 3 9793 2299 Fx: +61 3 9793 1799 E: Tech@spaelectrics.com.au

Pool fittings: Jets

- 40mm inlet, 40mm outlet
- 20/25mm airline (20mm for T-Jet only)
- 21mm or 13/16 socket for removing nozzle/jet/orifice.
- Equal pipe lengths between jets for best performance
- 30lpm outlet flow rate
- For use with eyeball returns.
- Pump sizes; general rule of thumb is $\frac{1}{4}$ hp per jet + $\frac{1}{4}$ hp for the length of pipe to the jets, approx. 10m
- Manifold all jets together but so that all jets have equal length of pipe and even distribution of water. See images below.
- Terminology: manifold; to create a manifold is to plump individual outlets (jets) together having a single inlet.
- Terminology: Air valve/screw cap it is the point on the coping/deck that allow the user to control the amount of air flow/suction into the jet.
- Recommended depth for use without blower is 300mm
- For best performance, use a blower on the airline
- If using a blower, there must be a check valve (one way valve) and a dry loop that is 600mm above the water level.
- If not using a blower, Airlines must have as little pipe below water line.
- Water pipe to extend approx. 100mm past last jet.

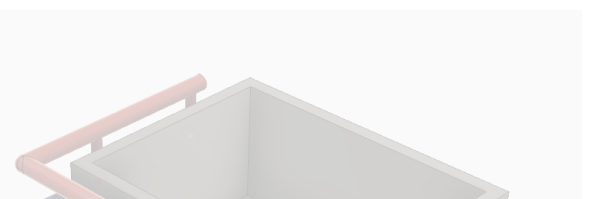
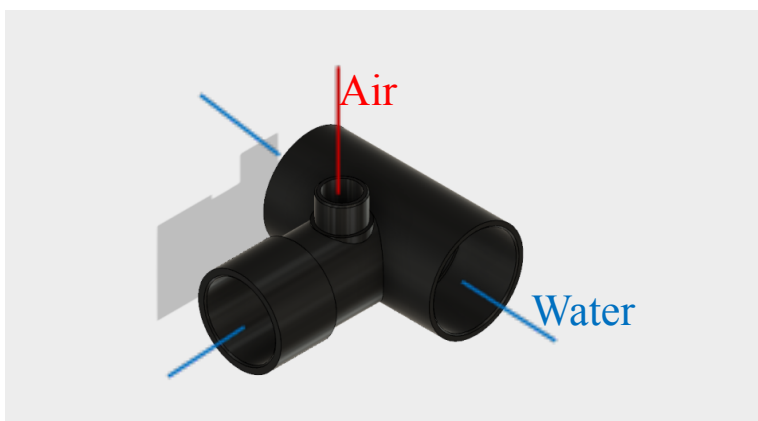
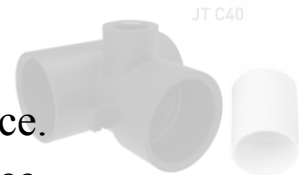

The BLUE pipe represents water pipe, and the RED represents air pipe.

