

AQUEA

V-LOCK LID

INSTALLATION & CARE GUIDE

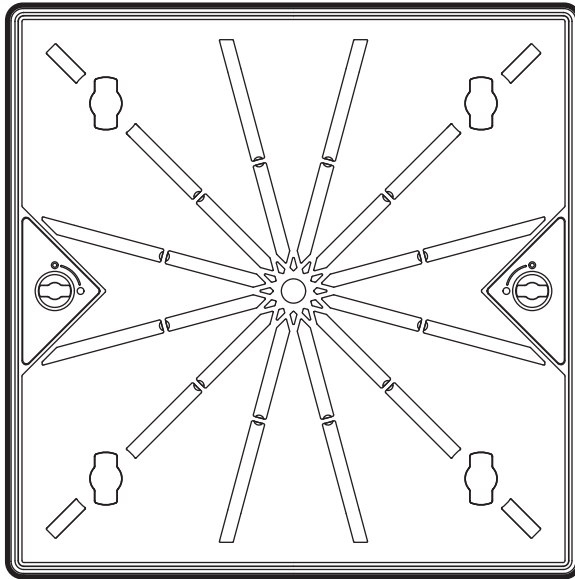

V40

V-SERIES V40 - PART NO. 475-231

⚠ NOTE:

1. READ THIS DOCUMENT PRIOR TO INSTALLATION. IMPROPER INSTALLATION WILL VOID WARRANTY.
2. PRODUCT ONLY TO BE INSTALLED & SERVICED BY A SUITABLY QUALIFIED PROFESSIONAL.
3. DO NOT USE ACID/CHEMICAL WASHES. DISCOLORATION MAY OCCUR AND WILL VOID WARRANTY.
4. INSTALLER TO ENSURE INSTALLATION MEETS ALL APPLICABLE ENGINEERING & REGULATORY REQUIREMENTS.
5. DO NOT CARRY LID WITH KEYS.
6. ALWAYS REMOVE KEYS FROM LID ONCE LOCKED. KEEP KEYS OUT OF REACH OF CHILDREN.
7. THIS MANUAL CONTAINS IMPORTANT INFORMATION. ONCE INSTALLATION IS COMPLETE INSTALLER MUST PROVIDE THIS MANUAL TO OWNER/OPERATOR TO STORE IN A SAFE PLACE.



IMPORTANT - PLEASE NOTE



1. SEE "GENERAL USAGE" SECTION FOR INSTRUCTIONS REGARDING CORRECT OPERATION OF LID (SEE PAGE 11)
2. DO NOT CARRY LID WITH LID KEYS AS THIS MAY RESULT IN INJURY OR DAMAGE
3. DO NOT USE HARSH CHEMICALS, ACIDS OR ABRASIVE MATERIALS TO CLEAN LID, OUTER FRAME OR LID KEY
4. KEEP LID KEYS OUT OF REACH OF CHILDREN. LID SHOULD ONLY BE OPERATED BY A CAPABLE ADULT
5. ENSURE FINGERS & TOES ARE CLEAR OF LID WHEN LOWERING TO AVOID INJURY
6. DO NOT OPEN SKIMMER WHILE PUMP IS OPERATING
7. DO NOT LEAVE KEYS IN LID WHEN NOT IN USE. STORE KEYS IN A SAFE PLACE
8. FOR SMOOTH AND RELIABLE OPERATION, KEEP YOUR V-LOCK LID FREE OF DIRT, SAND, LEAF MATTER AND DEBRIS



SAFETY FIRST



PLEASE ENSURE SUITABLE PERSONAL PROTECTION EQUIPMENT AND SAFE WORK PRACTICES ARE USED.

ALL V-LOCK LIDS ARE COVERED BY A 5 YEAR WARRANTY

See "WARRANTY POLICY" for further information

AUSTRALIAN DESIGNS NO. - 202310380, 202310379, 202310378

The contents of this manual are the exclusive copyright of AQUEA® and may not be reproduced without written permission. © 2024. Whilst every care was taken in preparation of this document, AQUEA® accepts no responsibility for the accuracy of the information supplied. Specifications subject to change without notice.

Ref: 475-893-01

CONTENTS

	PAGE
PARTS LIST	2
INSTALLATION OPTIONS	
STONE OR PAVER INSTALLATION	3
POURED CONCRETE INSTALLATION	8
GENERAL USAGE	11
PRODUCT DIMENSIONS	12
WARRANTY POLICY	13

PARTS LIST

V-LOCK V40 LID KIT

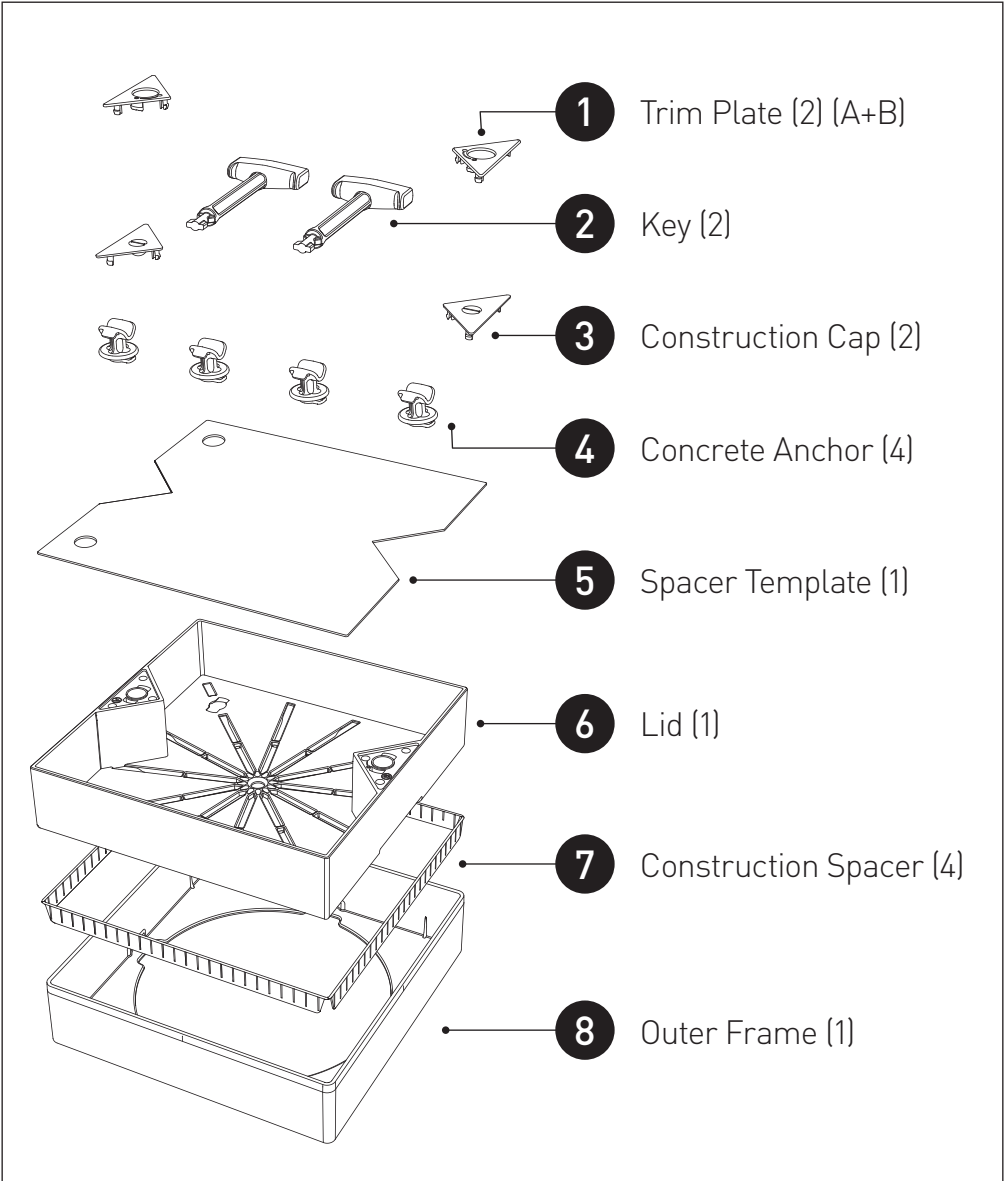

STONE OR PAVER INSTALLATION



BEFORE COMMENCING INSTALLATION

1. Remove lid supplied with skimmer box
2. **RECOMMENDED** - Using appropriate tape or equivalent, temporarily cover top opening of skimmer box to prevent concrete or debris falling into skimmer during installation. Remove once installation is complete.
3. Installation instructions assume a solid mounting substrate suitable for securely attaching components with adhesive. (e.g. concrete)
4. Check all kit components in "PARTS LIST" are present (See Page 2)
5. Remove Lid from Outer Frame using Keys (See GENERAL USAGE)

NEW BUILD

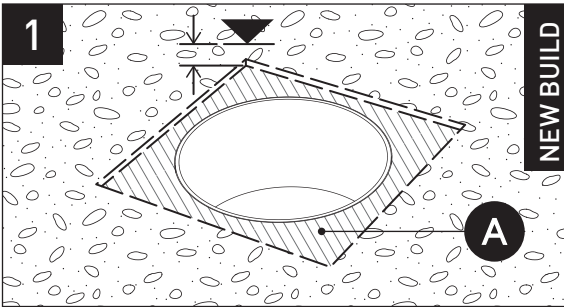

To correctly position Outer Frame:

- Determine finished height of installed stone/pavers.
- Confirm overall height of V-LOCK Lid (See Page 12).
- Prepare a level surface slightly larger than Outer Frame to suit finished paver height including allowance for mortar or adhesive under Outer Frame (A).

RETRO-FIT

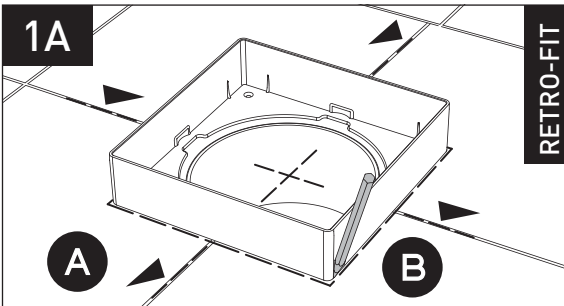

To correctly position Outer Frame:

- Align Outer Frame to existing skimmer box opening (A).
- Mark perimeter of Outer Frame on surrounding stone/pavers (B).

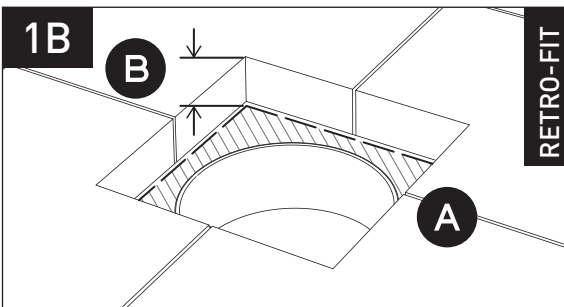

To create recess for Outer Frame:

- Carefully cut existing stone/pavers to create recess for Outer Frame (A).
- Remove debris to a depth suitable for overall height of V-LOCK Lid to be installed (See Page 12) including allowance for mortar or adhesive (B).

STONE OR PAVER INSTALLATION

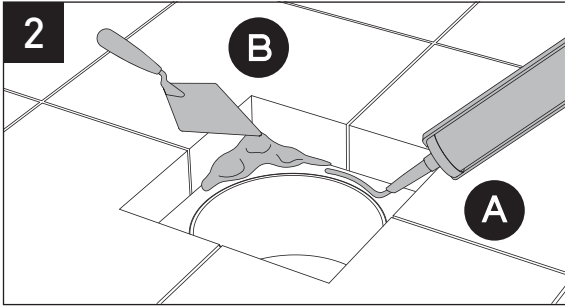

To prepare for Outer Frame install:

- Using an appropriate adhesive, apply a generous, even bead across mounting surface surrounding skimmer opening (A).
- OR**
- Using appropriate mortar mix, insert mortar into recess surrounding skimmer opening (B).

IMMEDIATELY REMOVE ANY MORTAR OR ADHESIVE THAT FALLS INTO SKIMMER

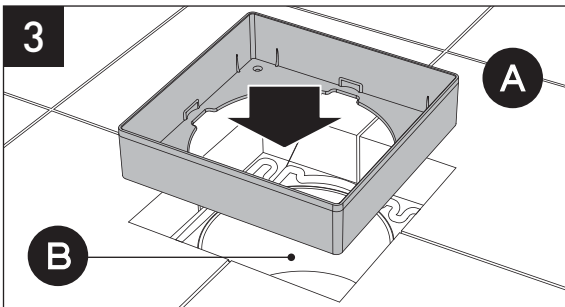

To install Outer Frame:

- Place Outer Frame on mortar or adhesive bed. Outer Frame must be fully supported (A).
- Ensure top rim of Outer Frame is flush with finished stone/paver surface.
- Remove any excess mortar/adhesive and ensure skimmer opening is fully accessible through Outer Frame (B).

IMMEDIATELY REMOVE ANY MORTAR OR ADHESIVE THAT FALLS INTO SKIMMER

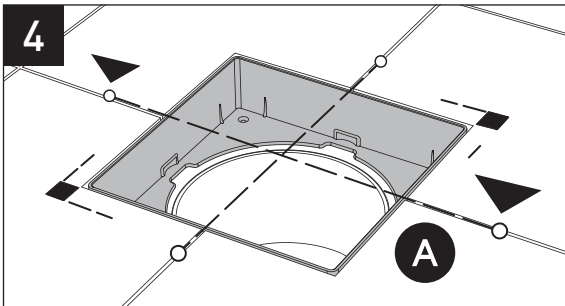

BEFORE MORTAR OR ADHESIVE IS CURED

To position Outer Frame:

- Adjust Outer Frame to ensure it is level, square and top rim is flush with finished stone/paver surface (A).

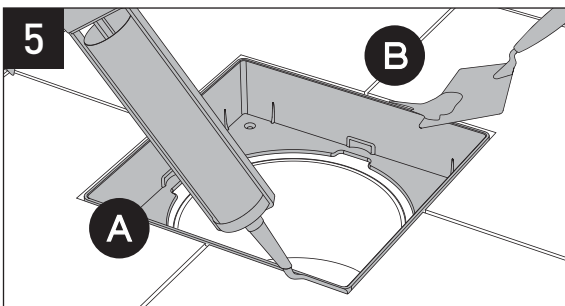

AFTER MORTAR OR ADHESIVE IS CURED

To finish Outer Frame:

- **RECOMMENDED** - Fill gap surrounding Outer Frame using a suitable expansion joint gap filler (A).
- **ALTERNATE** - Fill gap surrounding Outer Frame perimeter using preferred mortar/grout compound* (B).

IMMEDIATELY REMOVE ANY DEBRIS THAT FALLS INTO SKIMMER. ENSURE OUTER FRAME SIDES REMAIN STRAIGHT DURING GROUTING.

* Using rigid grout or mortar may result in gaps/cracking appearing over time due to natural expansion & contraction.

STONE OR PAVER INSTALLATION

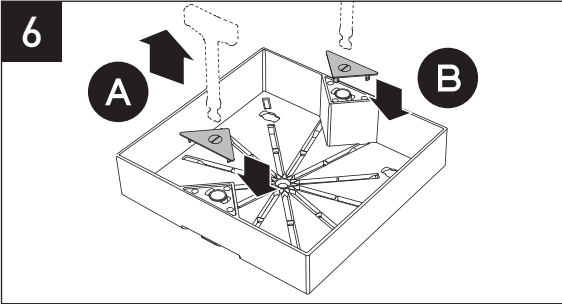

To prepare Lid for paver/stone installation:

- Remove Keys from Lid (A).
- Insert red Construction Caps to protect key openings (B)

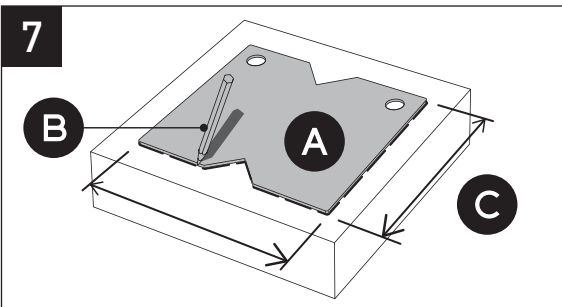

To mark paver/stone:

- Place inlay material with preferred surface facing upwards.
- Position Spacer Template on inlay material in desired position (A).
- Carefully mark perimeter cut-out profile including V-notches (B).
- Confirm dimensions shown match overall "F" & "G" dimensions on Page 12 (C).

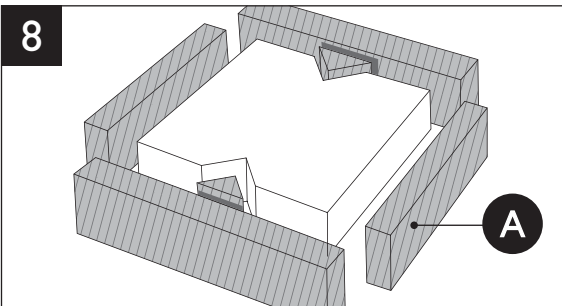

To cut inlay material to size:

- Carefully cut inlay as per marked perimeter including V-notches (A).

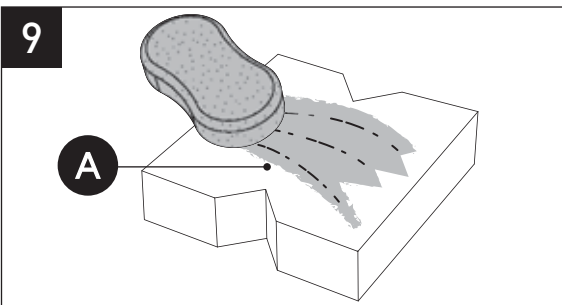

Prepare paver/stone for installation:

- Thoroughly clean and dry inlay on all sides (A).

ENSURE INLAY IS COMPLETELY DRY AND FREE FROM DUST, OIL, AND DEBRIS BEFORE CONTINUING.

STONE OR PAVER INSTALLATION

10A

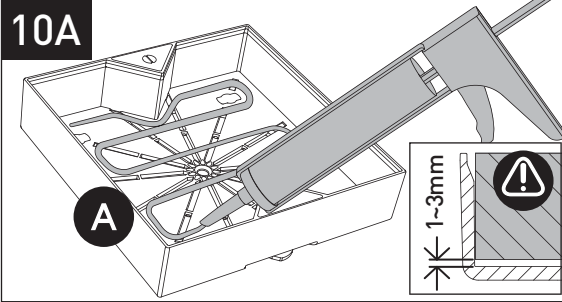

FOR INLAYS 1-3mm THINNER THAN INTERNAL LID DEPTH

To apply adhesive:

- Insert appropriate adhesive into caulkung gun & cut nozzle to provide a minimum 6mm wide bead.
- Apply a generous, even bead across entire internal surface of Lid (A).

10B

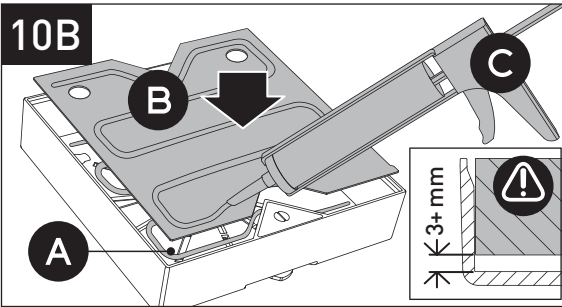

FOR INLAYS MORE THAN 3mm THINNER THAN INTERNAL LID DEPTH

To apply adhesive:

- Insert appropriate adhesive into caulkung gun & cut nozzle to provide a minimum 6mm wide bead.
- Apply a generous, even bead across entire internal surface of Lid (A).
- Insert Spacer Template into Lid (B).
- Apply generous, even bead across entire top surface of Spacer Template (C).

11

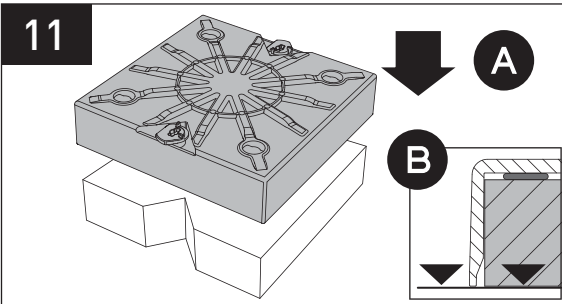

To install paver/stone into Lid:

- Place inlay material face-down on a flat work surface.
- Invert Lid and lower onto inlay material ensuring consistent adhesion across surface of inlay (A) until outer rim of Lid is touching work surface (B).

***DO NOT LOWER PAVER INTO LID*
LEAVE AND ALLOW ADHESIVE TO PARTIALLY CURE**

12

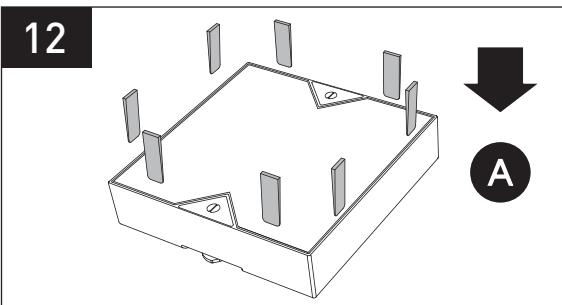

To position paver/stone:

- Carefully flip Lid over and check inlay is centred for consistent grout line thickness.
- If required insert tiling wedges or similar to adjust inlay to correct position (A).

ALLOW ADHESIVE TO FULLY CURE

STONE OR PAVER INSTALLATION

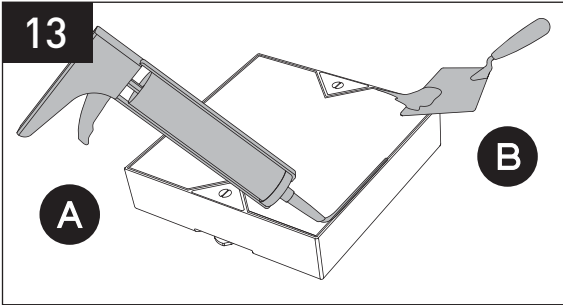

To finish Lid:

- **RECOMMENDED** - Fill gap surrounding inlay using an appropriate expansion joint gap filler (A).
- **ALTERNATE** - Apply preferred mortar or grouting compound (B)*.

DO NOT CLEAN LID WITH HARSH CHEMICALS, ACID WASHES OR ABRASIVE MATERIALS

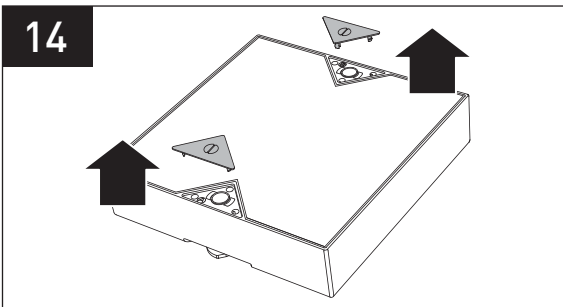

To prepare Lid for Trim Plates:

- Remove red Construction Caps.

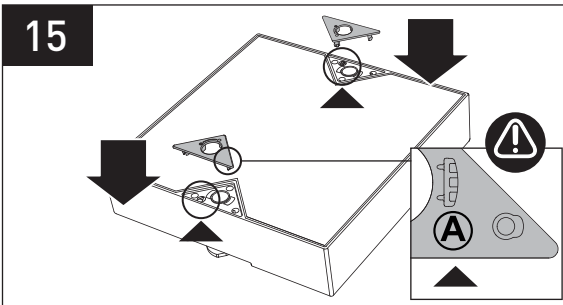

ENSURE "A" & "B" TRIM PLATES ARE INSERTED INTO CORRECT RECESSES

To assemble Trim Plates:

- Ensure key openings and surrounding recesses are clean & free from debris.
- Carefully clip Trim Plates into correct recess "A" or "B" as marked.

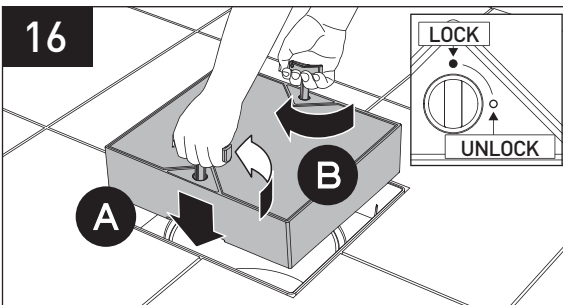

To finish installation:

- Insert Keys into Lid and rotate into the "Unlocked" position.
- Carefully lower Lid into Outer Frame (A).
- Rotate keys into "Locked" position (B) and remove both Keys from Lid.

**STORE KEYS IN SAFE PLACE.
KEEP KEYS OUT OF REACH OF CHILDREN.**

* Using rigid grout or mortar may result in gaps/cracking appearing over time due to natural expansion & contraction.

POURED CONCRETE INSTALLATION



BEFORE COMMENCING INSTALLATION

1. Remove lid supplied with skimmer box
2. **RECOMMENDED** - Using appropriate tape or equivalent, temporarily cover top opening of skimmer box to prevent concrete or debris falling into skimmer during installation. Remove once installation is complete.
3. Installation instructions assume a solid mounting substrate suitable for securely attaching components with adhesive. (e.g. concrete)
4. Check all kit components in "PARTS LIST" are present (See Page 2)
5. Remove Lid from Outer Frame using Keys (See GENERAL USAGE)

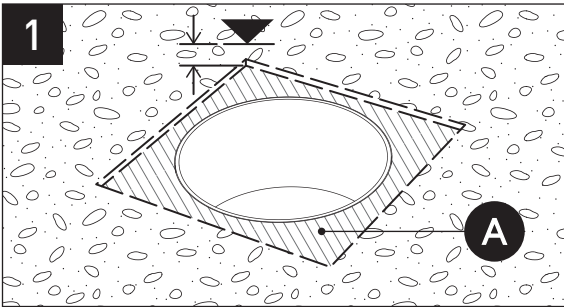

To correctly position Outer Frame:

- Determine finished height of concrete including allowance for loss due to grinding or polishing processes.
- Confirm overall height of V-LOCK Lid (See Page 12).
- Prepare a level surface slightly larger than Outer Frame to suit finished concrete height including allowance for mortar or adhesive under Outer Frame (A).

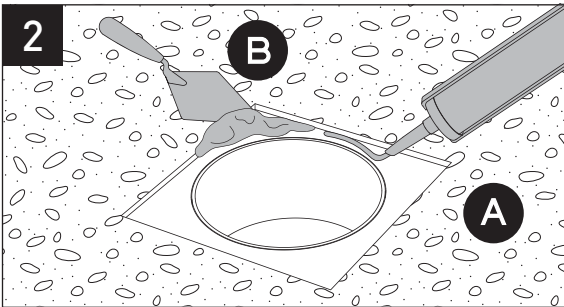

To prepare for Outer Frame install:

- Using an appropriate adhesive, apply a generous, even bead across mounting surface surrounding skimmer opening (A).
- OR**
- Using appropriate mortar mix, apply mortar bed on surface surrounding skimmer opening (B).

IMMEDIATELY REMOVE ANY MORTAR OR ADHESIVE THAT FALLS INTO SKIMMER

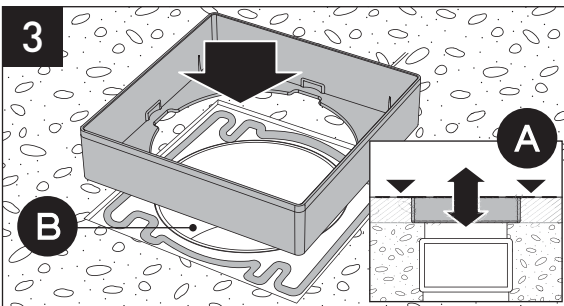

To install Outer Frame:

- Place Outer Frame on mortar or adhesive bed. Outer Frame must be fully supported.
- Ensure top rim of Outer Frame is flush with finished concrete surface (A).
- Remove any excess mortar/adhesive and ensure skimmer opening is fully accessible through Outer Frame (B).

IMMEDIATELY REMOVE ANY MORTAR OR ADHESIVE THAT FALLS INTO SKIMMER

POURED CONCRETE INSTALLATION

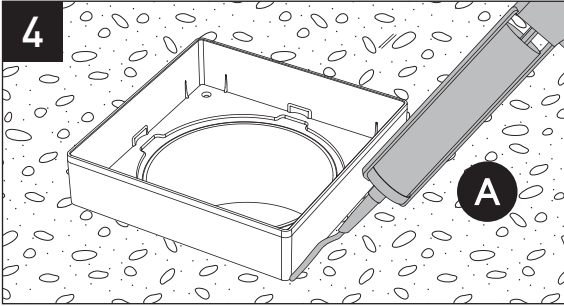

To seal Outer Frame:

- Apply a continuous bead around lower edge of Outer Frame using an appropriate flexible joint sealant (A). Ensure join is fully sealed to prevent concrete leaking under Outer Frame during pouring process.

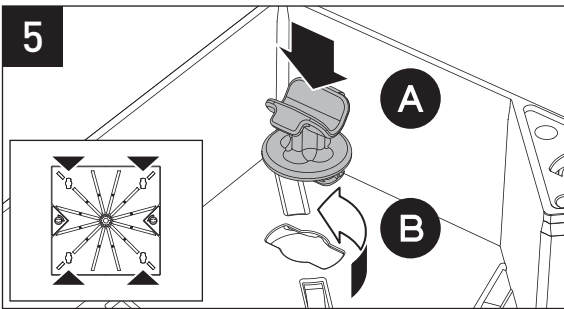

To prepare Lid for concrete:

- Insert Concrete Anchors into Lid floor (4 places) (A).
- Rotate each Concrete Anchor 90 degrees to lock in place (B).

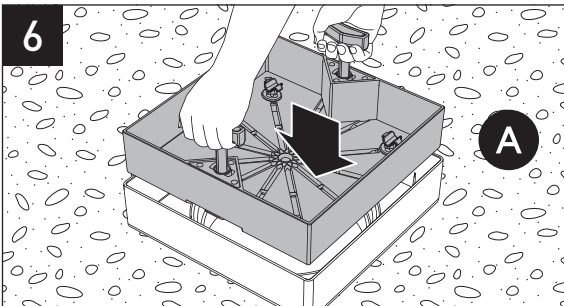

To insert Lid:

- Using Keys insert Lid into Outer Frame and lock in place ensuring latches engage correctly in Outer Frame (A).

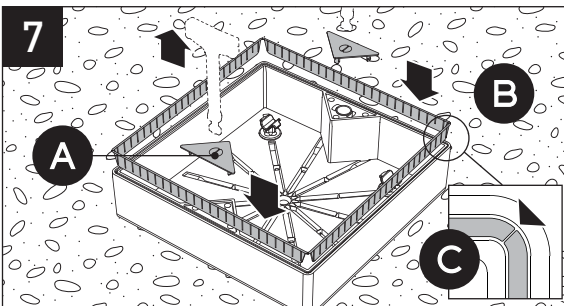

To prepare for concreting:

- Remove Keys.
- Insert red Construction Caps to protect Key openings (A).
- Carefully insert red Construction Spacers into slots between Lid & Outer frame (4 places) (B).
- Ensure Construction Spacers are fully inserted and corners are correctly aligned (C).

POURED CONCRETE INSTALLATION

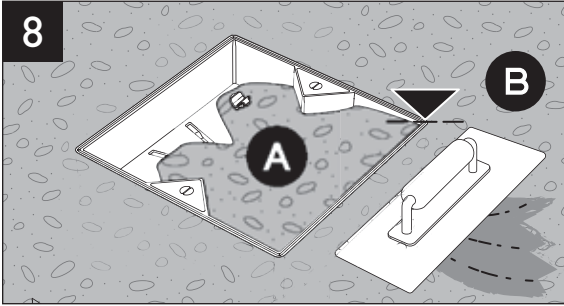

To complete concreting:

- Pour concrete around Outer Frame and into Lid and remove all voids (A).
- Check Outer Frame has remained at correct height & position.
- Carefully trowel concrete flush with top rim removing any excess (B). Apply desired finish to concrete.

REMOVE ANY CONCRETE THAT FALLS INTO SKIMMER IMMEDIATELY. ENSURE RED CONSTRUCTION CAPS & SPACERS ARE FULLY VISIBLE BEFORE CONCRETE SETS.

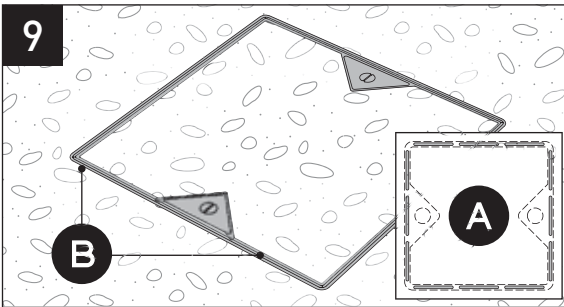

IF GRINDING OR POLISHING CONCRETE

To apply finish to concrete:

- Carefully grind over lid ensuring surface remains flat and level. Depth indicators will become visible on Construction Spacers when within 1mm of top rim of Lid (A).
- Carefully finish grind or polish until Construction Spacers and rim of Lid & Outer Frame are fully visible (B).

AVOID CUTTING INTO TOP RIM OF LID & OUTER FRAME DURING GRINDING

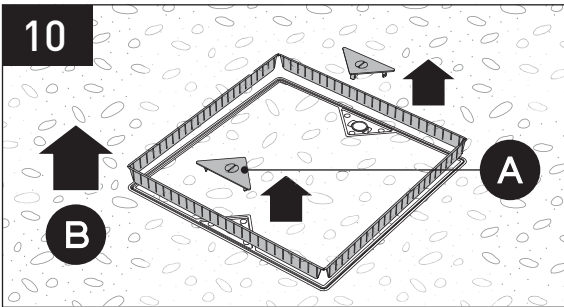

AFTER FINISHING IS COMPLETE

To prepare Lid for Trim Plates:

- Remove Construction Caps (A).
- Carefully remove Construction Spacers (B).

HELPFUL TIP

It may be easier to release Construction Spacers by carefully lifting Lid out of Outer Frame using Keys.

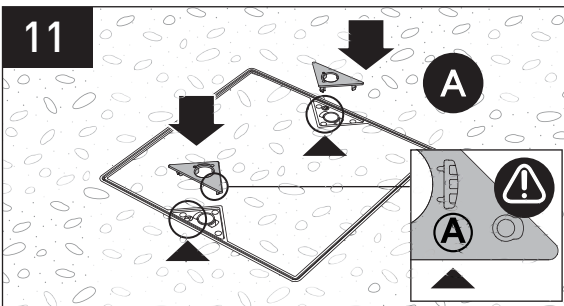

ENSURE "A" & "B" TRIM PLATES ARE INSERTED INTO CORRECT RECESSES

To assemble Trim Plates:

- Ensure key openings and surrounding recesses are clean & free from debris.
- Carefully clip Trim Plates into correct recess "A" or "B" as marked.

GENERAL USAGE

OPENING LID

To unlock Lid:

- Insert Keys into Lid openings (A).
- Rotate Keys 90 degrees to unlock position (B).
- Keys are now captive in Lid.

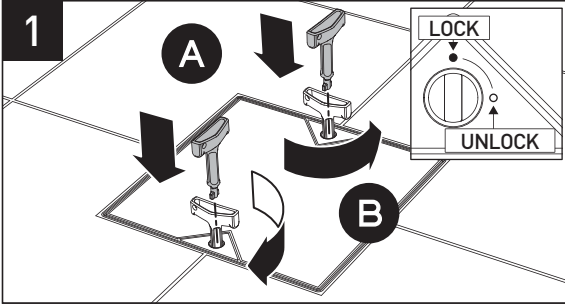

To remove Lid:

- Using Keys as handles lift Lid upwards (A) and remove from Outer Frame.
- Carefully place Lid down next to skimmer box opening.



LID MAY BE HEAVY. PLEASE TAKE CARE WHEN LIFTING OR SEEK ASSISTANCE.

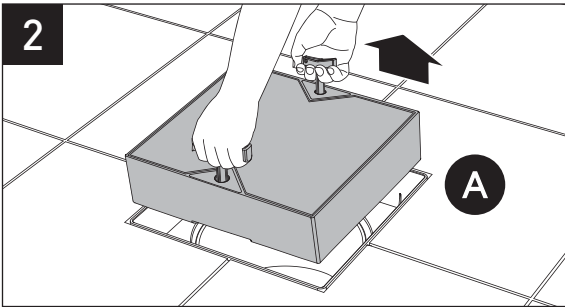

CLOSING LID

To replace Lid:

- Using Keys as handles, carefully lower Lid into Outer Frame (A).



LID MAY BE HEAVY. PLEASE TAKE CARE WHEN LIFTING OR SEEK ASSISTANCE.

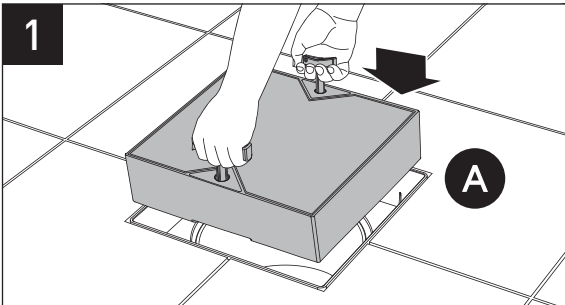

To lock Lid:

- Rotate keys 90 degrees into "Locked" position (A) ensuring latches engage correctly in Outer Frame.
- Remove both Keys from Lid (B).

**STORE KEYS IN SAFE PLACE.
KEEP KEYS OUT OF REACH OF CHILDREN.**

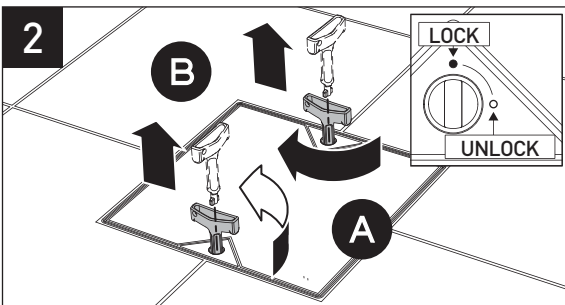

V40 - DIMENSIONS*

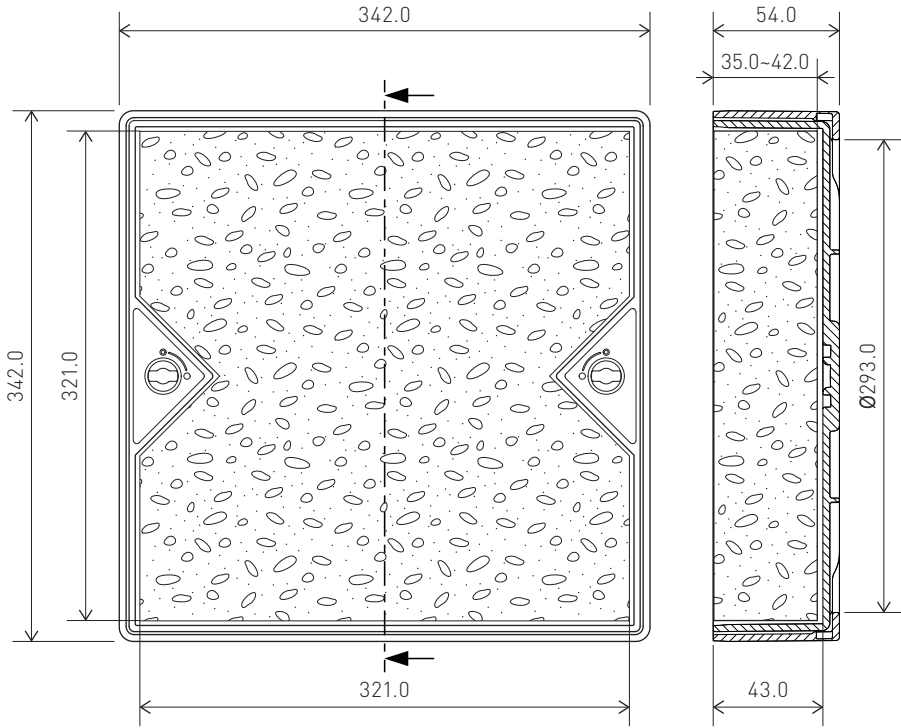

* TOLERANCE: +/- 1.0mm

WARRANTY POLICY

[AU Policy Revision 04]

AQUEA (AQUEA Pty. Ltd.) warrants that, subject to the exclusions and limitations below, its products will be free from defects in materials and workmanship for a minimum period of 12 MONTHS from the date of purchase. All warranty periods commence on the date of purchase by the customer and are only valid in original country of purchase. The provisions of this warranty are not transferable.

If a defect appears in any Product supplied by AQUEA before the end of the Warranty Period due solely to defective materials or workmanship, AQUEA will in its sole discretion, and subject to these terms and conditions, either:

- a) repair the Product or the defective part of the Product free of charge; or
- b) have the Product or the defective part of the Product repaired by a qualified repairer free of charge; or
- c) replace the Product.

AQUEA at its sole discretion may replace defective parts of the Products with parts and components of similar quality, grade and composition where an identical part or component is not available. Refurbished parts may be used to repair the Products.

All repairs are to be carried out by AQUEA or its authorised repairer only. This warranty does not cover any costs related to travel, removal or re-installation associated with repair or replacement of the Product.

TO MAKE A WARRANTY CLAIM

To claim under this warranty the customer should immediately cease use of the Product once alleged defect is identified, and contact AQUEA within 30 days.

To make a claim the customer must:

1. Provide the following information:

- (a) proof of purchase disclosing date and place of purchase;
- (b) full details of the alleged defect; and
- (c) any other appropriate documentation.

2. The customer must make the Product or site available to AQUEA or its authorised repair agent for inspection and testing. If such inspection and testing finds no defect in the Product, the customer must pay AQUEA's usual costs of service work and testing.

3. The customer agrees to pay AQUEA's usual charges (including any service fee) for any goods or services provided by AQUEA not covered by this product warranty.

4. The customer is responsible for the cost of transport and all insurance of the Product to and from AQUEA or its authorised repair agent.

WARRANTY CONDITIONS

This warranty only applies where the following conditions are met:

1. The customer complies with the following general maintenance requirements:

- (a) The Product is maintained free from general debris or foreign matter.
- (b) The Product is maintained and serviced regularly (at least every 12 months) by a suitably qualified professional.
- (c) Where applicable, the Product is replaced at specified intervals as outlined in product literature by AQUEA.

2. Where applicable, Product has been used in pool or spa water which:

- (a) is maintained within a pH range of 7.2-7.6, and chemically balanced as per accepted industry standards.
- (b) is regularly (at least once a month) treated with a sanitising system in compliance with applicable regulatory recommendations or regulations.
- (c) has not exceeded 40 degrees Celsius in temperature.
- (d) has not been exposed to freezing conditions.

WARRANTY EXCLUSIONS

This warranty will not apply where:

- (a) the Product has not been installed in accordance with the installation instructions provided with the Product, any statutory requirements and these terms and conditions;
- (b) the Product has not been installed by a suitably qualified professional trained in the installation and operation of such products with more than 12 months industry experience;
- (c) a failure to observe and comply with the instructions supplied with product for the proper use, service or maintenance of the Product has occurred;
- (d) the Product has been used for a purpose other than that for which it was designed and manufactured;
- (e) removal or installation of the Product has contributed to, or resulted in, the defect or damage;
- (f) the Product has been repaired, altered or modified by someone other than AQUEA or its authorised agent;
- (g) substitute or replacement parts not provided by AQUEA have been used;
- (h) the defect has arisen due to abuse, misuse, neglect, or accident;
- (i) the Product has been subject to abnormal conditions, including environment, temperature, water, fire or other acts of nature;
- (j) the Product has been subject to abnormal corrosive conditions or abrasive chemicals;
- (k) the defect is the result of corrosion or normal wear and tear;
- (l) the defect is the result of insect and/or vermin infestation;
- (m) concrete, cement, render, pebbles or other pool surface finishes contribute to the defect, or inhibit proper function of the Product;
- (n) the damage occurred in transit;
- (o) after testing and inspection AQUEA cannot establish any fault in the Product;
- (p) the Product has been used in a commercial application;
- (q) the Product has not been supplied by AQUEA;
- (r) the defect is related to any cause other than a defect in the materials or workmanship of the Product.

LIMITATIONS

AQUEA makes no express warranties or representations other than set out in this warranty.

Except to the extent required by the Australian Consumer Law, the repair or replacement of the Product or part of the Product is the absolute limit of AQUEA's liability under this express warranty.

To the extent permitted by law, AQUEA will not be liable for:

- (a) Damage to any other property caused by defect in the Product.
- (b) Any indirect, special or consequential loss arising from or related to defects in the Product, including, but not limited to, loss of time, loss of use of the product, loss of business opportunity, loss of profits, loss of revenue, loss of goodwill, or inconvenience.
- (c) Any other damage as a result of weather or natural disaster.
- (d) Any claim against the customer by other parties.

Our goods come with guarantees that cannot be excluded under the Australian Consumer Law. You are entitled to a replacement or refund for a major failure and for compensation for any other reasonably foreseeable loss or damage. You are also entitled to have the goods repaired or replaced if the goods fail to be of acceptable quality and the failure does not amount to a major failure.

The benefits of this warranty are in addition to any rights and remedies imposed by Australian State and Federal legislation that cannot be excluded. Nothing in this warranty is to be interpreted as excluding, restricting or modifying any State or Federal legislation applicable to the supply of goods and services which cannot be excluded, restricted or modified.

CONTACT

For warranty claims visit www.aquea.com.au or contact AQUEA using details overleaf.

BUILD A
BETTER
POOL

AQUEA

WWW.AQUEA.COM.AU

U11/22-24 REDLAND DRIVE, MITCHAM, VICTORIA 3132.
SALES & SUPPORT ENQUIRIES - HELLO@AQUEA.COM.AU
PHONE - 0481 875 870